



HYDRIVE SERIES

HYDRAULIC COOLERS

Unique design

Compact size allows for easy installation on tractors and trucks with minimal space on chassis rails. The compact design with a low noise level centrifugal fan provides maximum performance and heat dissipation up to 13.5HP (10kW) on 2010 models and 26 HP (20kW) on 2020 models.

Built for performance

Constructed from stainless steel materials to withstand the harsh environmental and operation conditions. The light weight cooler with a small hydraulic oil reservoir, reduces the concern and hazard of costly spills.

Maintenance Friendly

The easy to read restriction gauge mounted on the front of the Hydrive indicates when the spin-on oil filter should be replaced. Normal hydraulic oil maintenance is made easy with the reservoir drain on the Hydrive tank.

Options and Accessories

- Optional Control Valve on 2010 Models
- Complete Hydraulic System Packages
- Hydraulic motor Adapters for blackmer Pumps

	Part nbr	Type of flange	Selective valve
HYBRIDE 2010	512819.00	BSP	NO
	512820.00	BSP	YES
	512823.00	NPT	NO
	512822.00	NPT	YES
HYBRIDE 2020	512927.00	BSP	NO
	512929.00	NPT	NO



Hydrive 2010

Operations Parameters

Oil Flow Rate	15 - 26 US	55 - 100 l/min
Circuit Pressure	750-4400 PSI	50 - 300 BAR
Fan Speed	2800 RPM	
Return Pressure	15 - 75 PSI	1 - 5 BAR
Heat Dissipation	13.5HP for 70° F Temp.Rise	10 kW for 40° C Temp.Rise
Fan Motor Flow	2,2 US GPM	5,5 l/min
Weight (dry)	53 lbs	24 kg
Oil Tank Capacity	10 liters	2,5 US Gallons

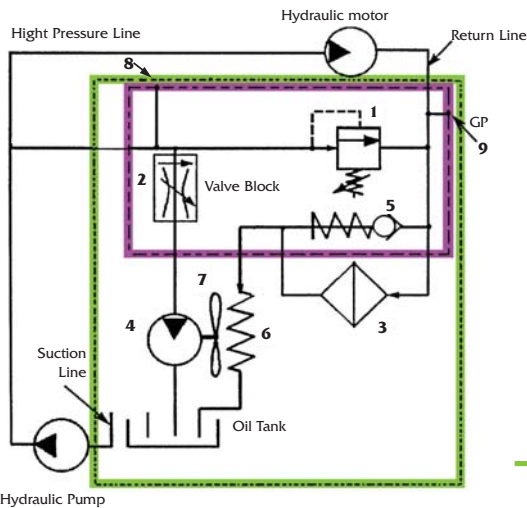
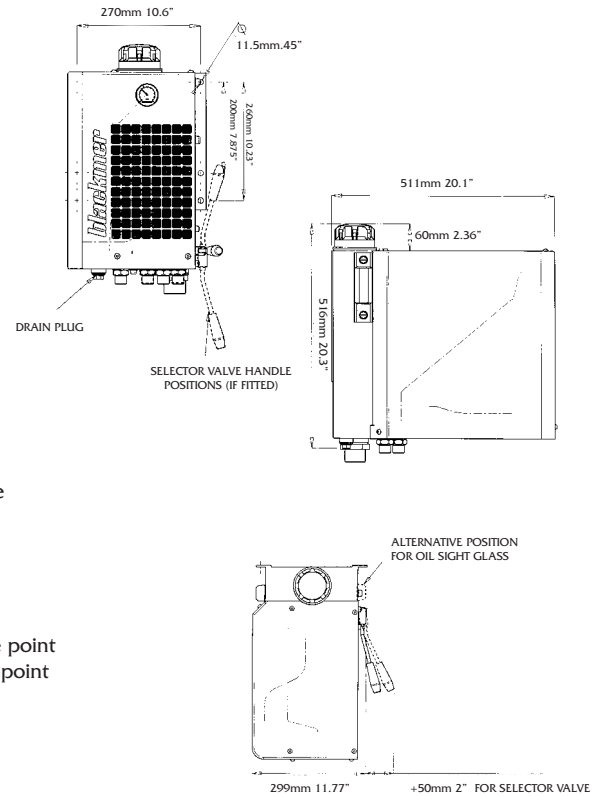

- 1- Adjustable relief valve
- 2- Fan speed control valve
- 3- Return line filter
- 4- Fan motor
- 5- Filter by-pass valve
- 6- Oil cooler radiator
- 7- Fan
- 8- System pressure gauge point
- 9- Return pressure gauge point

Hydrive

Valve block

Hydrive 2020

Operations Parameters

Oil Flow Rate	15 - 50 US GPM	55 - 190 l/min
Circuit Pressure	750-4400 PSI	50 - 300 BAR
Fan Speed	2800 RPM	
Return Pressure	15 - 75 PSI	1 - 5 BAR
Heat Dissipation	26 HP for 70° F Temp.Rise	20 kW for 40° C Temp.Rise
Fan Motor Flow	2.2 US GPM	8.8 l/min
Weight (dry)	77 lbs	35 kg
Oil Tank Capacity	17 liters	4.5 US Gallons

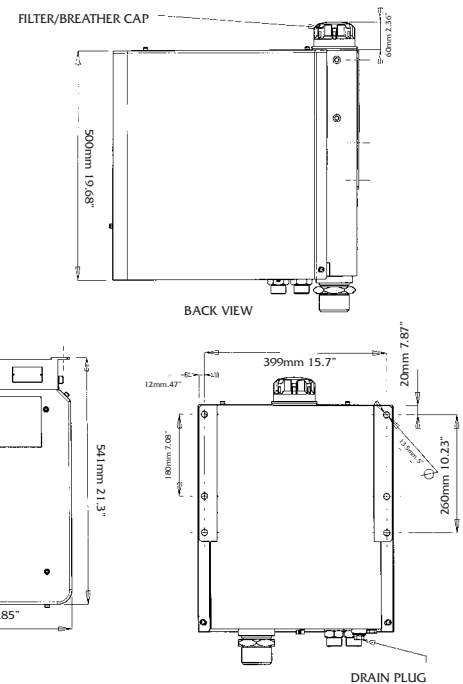

Sales information and Equipment Application Assistance

Blackmer has a world wide distribution network to assist you in specifying any of our family of pumps, compressors and other equipment for your application.

For more information or to find the distributor nearest to you, please contact us as the telephone, fax or internet address listed below.



1809 Century Avenue, Grand Rapids, MI 49503-1530 U.S.A. • Telephone : 616 241 1611 • Fax : 616 241 3752
 ZI La Plaine des Isles, rue des Caillottes, 89000 Auxerre, France • Téléphone : +33 3 86 49 87 16 • Fax : +33 3 86 49 87 17
 E-mail : contact@blackmer-mouvex.com
 Auf dem Zehnthöbel 22, D - 64572 Büttelborn-Worfelden, Germany • Telefon: +49 (0) 6152 9869-0 • Fax: +49 (0) 6152 9869-10
 E-mail : willkommen@blackmer-mouvex.com

www.blackmer.com

Distributed by :